

CE-172

Low Profile Wall Mount Bracket for Monitor

- Two Piece Design for Quick and Easy Installation
- Mounts monitor only .0625" (5/8") away from the surface
- VESA 75mm and 100mm Compliant
- Includes Wall Quick-Mount Plate, Monitor Plate and M4x10 Screws
- UL Listed
- Recommended for use with TRU-Vu Monitors up to 44 lbs.



Low Profile Monitor Wall Mount Bracket for monitors and touchscreens is a popular model. It is VESA 75mm and 100mm compliant and can mount the monitor only 5/8" away from the surface. We recommend our TRU-Vu slim mount monitor bracket for use with monitors up to 44lbs. Learn more about [VESA](#). View our associated [products](#) to choose the monitor or touchscreen for your application.

Material: Steel

Dimensions: (Overall) 6.25" x 5" x 5" (15.87 x 127 x 127 mm)



Weight: 12 Lbs (.544kg)

How Do I Mount My TRU-Vu Monitor?

- Many of our monitors are supplied with a tabletop base. (See the respective data sheet)
- We offer optional tabletop bases and wall mount brackets for all monitors. See our [Mounting Brackets and Bases](#) for more details and available styles.
- All TRU-Vu monitors 8.4" and larger have 4 industry-standard VESA screw holes for mounting. These are arranged in a square pattern, 75 x 75 mm, 100 x 100 mm or 200 x 200 mm center-to-center. Monitors from 8.4" to 32" use M4 screws. They should sink into the monitor no more than 6-7 mm. Monitors 42" and larger use M6 screws. They should sink into the monitor no more than 7 mm. VESA mount hole patterns range from 100 x 100 mm to 200 x 200 mm.
- [CE-172 Installation Guide](#)

DIMENSIONS (MM)

DIMENSIONS:

Unit: INCHES

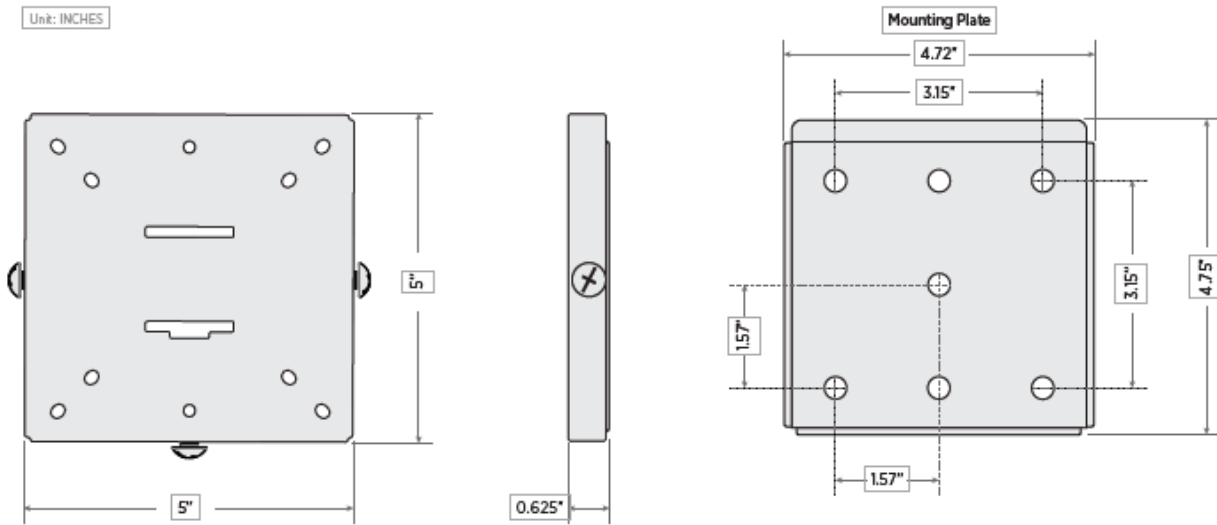

CE-172 Drawing